



&BEYOND

## NXABEGA OKAVANGO TENTED CAMP

### *Family Suite*



## BOTSWANA

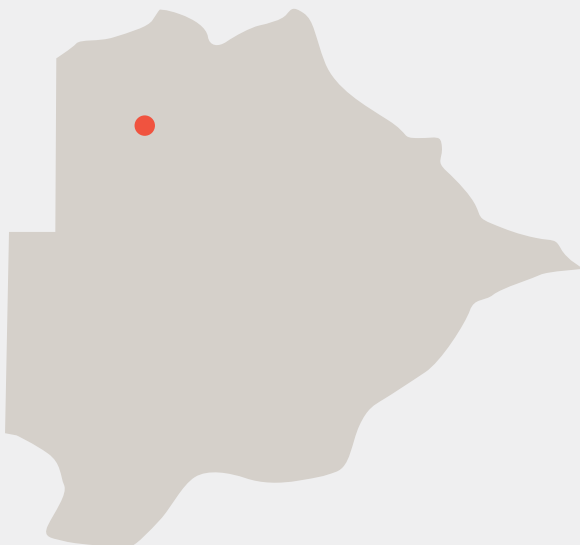

## FAMILY TRAVEL

Meaning "Place of the Giraffe", &Beyond Nxabega Okavango Tented Camp is ideally positioned in an exclusive wildlife concession, and offers wonderful opportunities to explore the magnificence of the Okavango Delta. The wide open channels of the Delta spread in front of the camp, inviting guests to discover a world full of adventure.

This is the perfect destination for group or family travel. The camp boasts a spectacular interleading family suite that can accommodate two adults and two children (three on special request). The family suite, consisting of two luxury tents joined by a walkway, offers the perfect setting for families to enjoy the wonders of the Delta. Each spacious tent features a luxurious bed that faces the beautiful views of a reed-filled floodplain, and an ensuite bathroom with an indoor and al fresco shower as well as a sprawling veranda, with a spacious sitting area and a private sala.

## WILDCHILD PROGRAMME

The Okavango Delta is a wonderful playground for little ones to explore. As with all of our lodges, &Beyond Nxabega Okavango Tented Camp has a fun-filled WILDChild programme for children to enjoy during their stay. Children will have the opportunity to partake in an assortment of activities that have been carefully planned according to their fun-factor such as baking in the kitchen with the lodge's chefs, tracking small wildlife, bug finding missions, fishing and lily-necklace making.

FAMILY SUITE CONFIGURATION	OCCUPANCY
1 family suite (2 suites linked by an enclosed walkway)	Maximum 2 adults + 2 children (3 children on special request)

*“Get your children travelling early.  
Expose them to the people, the food and the  
real culture of your destination,”*

Joss Kent, &Beyond CEO

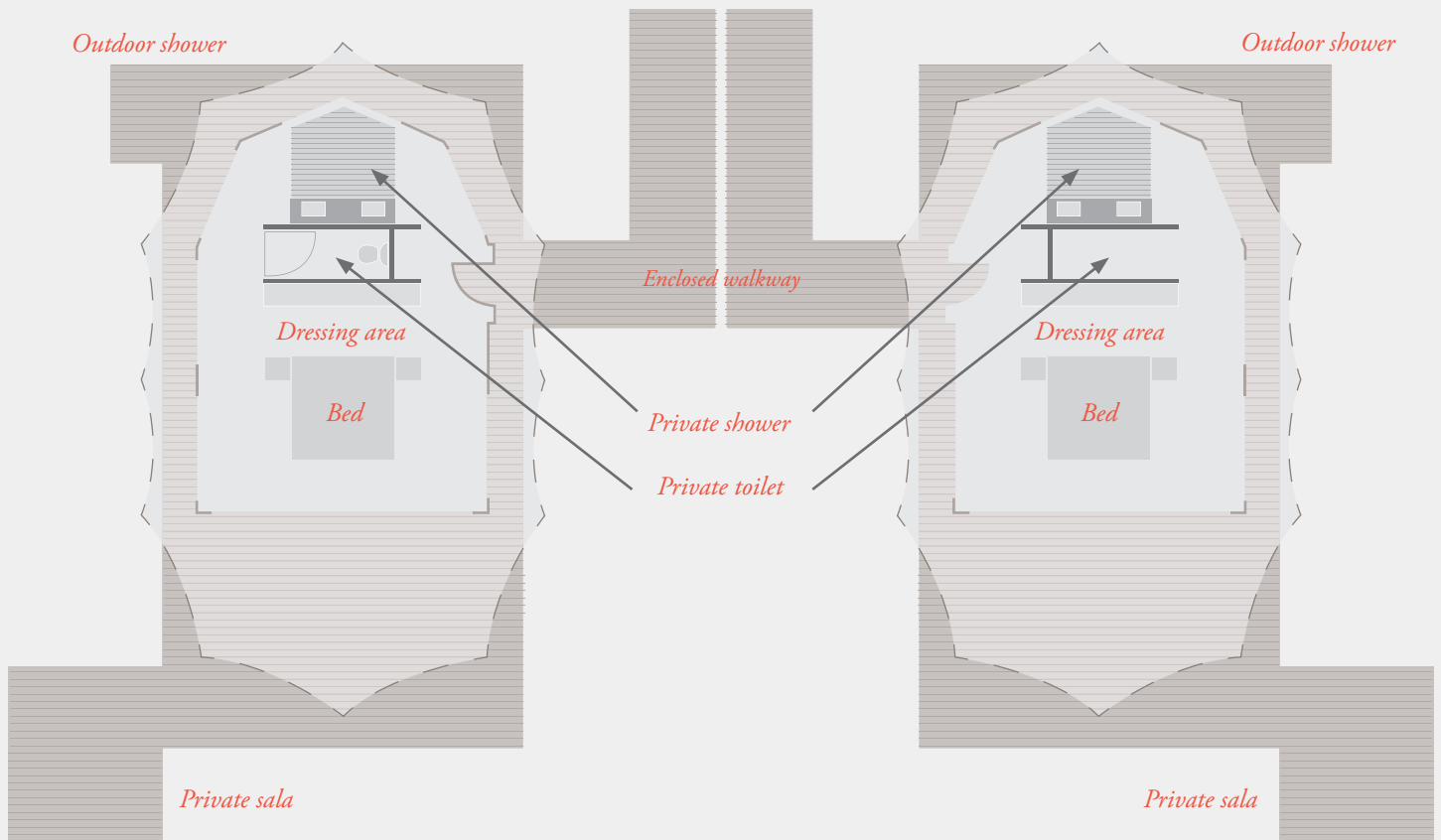

#### GAME DRIVE POLICY AT &BEYOND NXABEGA OKAVANGO TENTED CAMP







The below policy applies to children on shared game drives and boating activities\*.

AGE OF CHILD	GAME VIEWING PARTICIPATION**
0 – 2 years	<ul style="list-style-type: none"> <li>Not permitted on game viewing activities</li> </ul>
3 – 5 years	<ul style="list-style-type: none"> <li>Not permitted on game viewing activities; however, shortened children's game drives available on request</li> </ul>
6 – 11 years	<ul style="list-style-type: none"> <li>Permitted on game drives and boating activities, at the discretion of the lodge manager</li> <li>Not permitted on nature walks or mokoro activities</li> </ul>
12 – 16 years	<ul style="list-style-type: none"> <li>Permitted on game drives, nature walks and boating activities</li> <li>16 years and older permitted on mokoro excursions</li> </ul>

\*A private vehicle (subject to availability and at an additional cost) can be booked when staying at &Beyond Nxabega Okavango Tented Camp, allowing children of all ages to participate in a game drive. Access to sightings will be at the discretion of the guide, based on the behaviour of both the child and animals. Greater distances from animals may be adhered to, or certain sightings may be avoided, in order to ensure the safety of all. In the case of boating activities, the availability of boats may restrict private use and require forward planning.

\*\* Whilst there are age restrictions for children permitted on game viewing activities, all ages will be accommodated on game drive and boat transfers to-and-from the lodge.

[www.andBeyond.com](http://www.andBeyond.com)

-  [facebook.com/andBeyondTravel](https://facebook.com/andBeyondTravel)
-  [instagram.com/andBeyondTravel](https://instagram.com/andBeyondTravel)
-  [twitter.com/andBeyondTravel](https://twitter.com/andBeyondTravel)
-  [youtube.com/andBeyondAfrica](https://youtube.com/andBeyondAfrica)
-  [blog.andBeyond.com](http://blog.andBeyond.com)
-  [www.rhinoswithoutborders.com](http://www.rhinoswithoutborders.com)